

Ombra/ floating jamb with shadow reveal

EURO DOOR



DAYORIS
DOORS

Types of Applications



Finishes

Primed / Laminated Import

Laminated Suncrest / Matte Lacquer

Wood veneer

Cabinet Knob



L Profile



Cabinet Style Hinge



What's included

Technical Specifications:

1" Solid Core MDF Door

Finish – Designer's choice

Frame – Concealed aluminum

Design – Designers Choice

Frame Profile Finishes

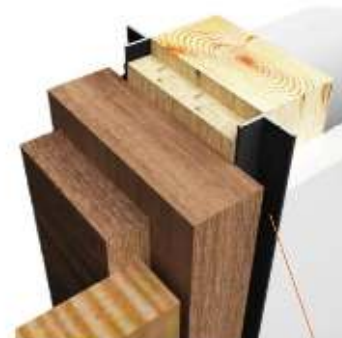

Shadow reveal by others

* Optional Upgrades

Benefits of Ombra/ euro door

Any Wall Thickness

Lighter Door and Space saver

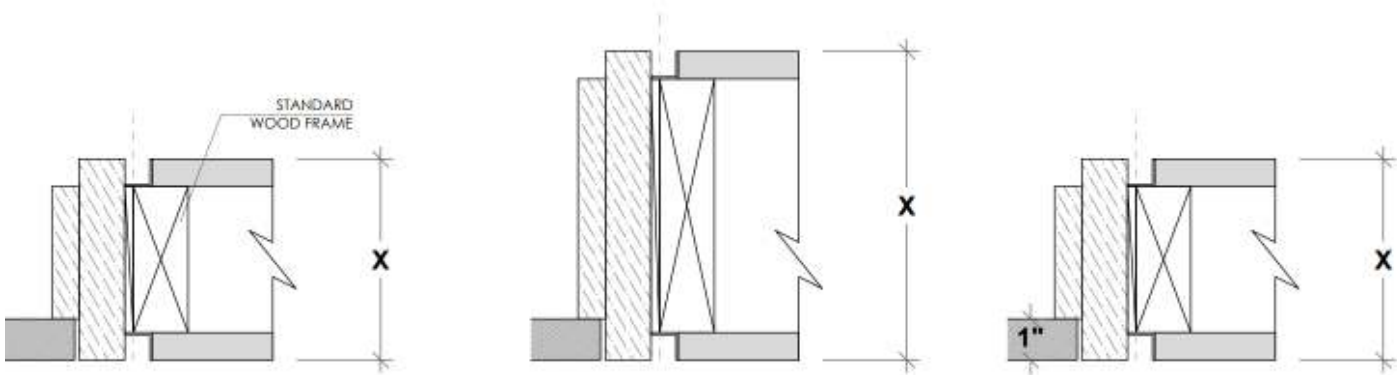

A thinner, economical application for non walk-in closets

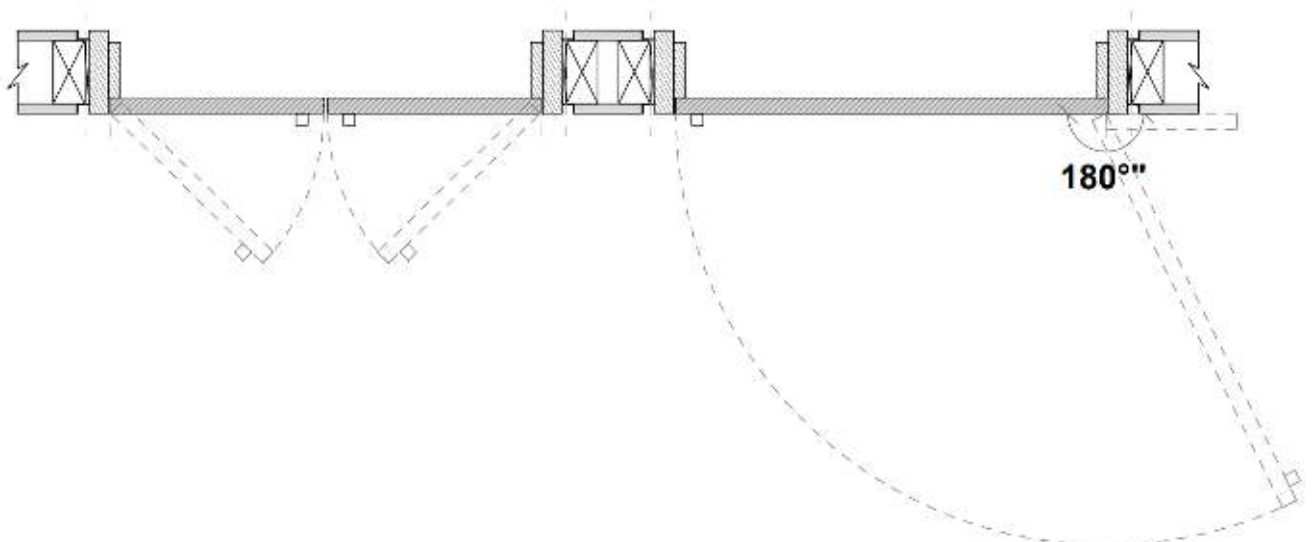

Works with 1/2" depth reglet (any height). Can be used with 5/8" drywall.

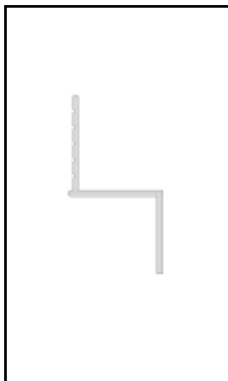

DEPTH	WIDTH	NON-VENTED
1/2"	1/8"	DRMZ-25-125
1/2"	1/4"	DRMZ-50-25
1/2"	3/8"	DRMZ-50-375
1/2"	1/2"	DRMZ-50-50
1/2"	5/8"	DRMZ-50-625
1/2"	3/4"	DRMZ-50-75
1/2"	1"	DRMZ-50-100
1/2"	1 1/2"	DRMZ-50-150
1/2"	2"	DRMZ-50-200

* Fry reglet for reference purposes only, not provided by Dayoris.

Framing Instructions Ombra/ euro door

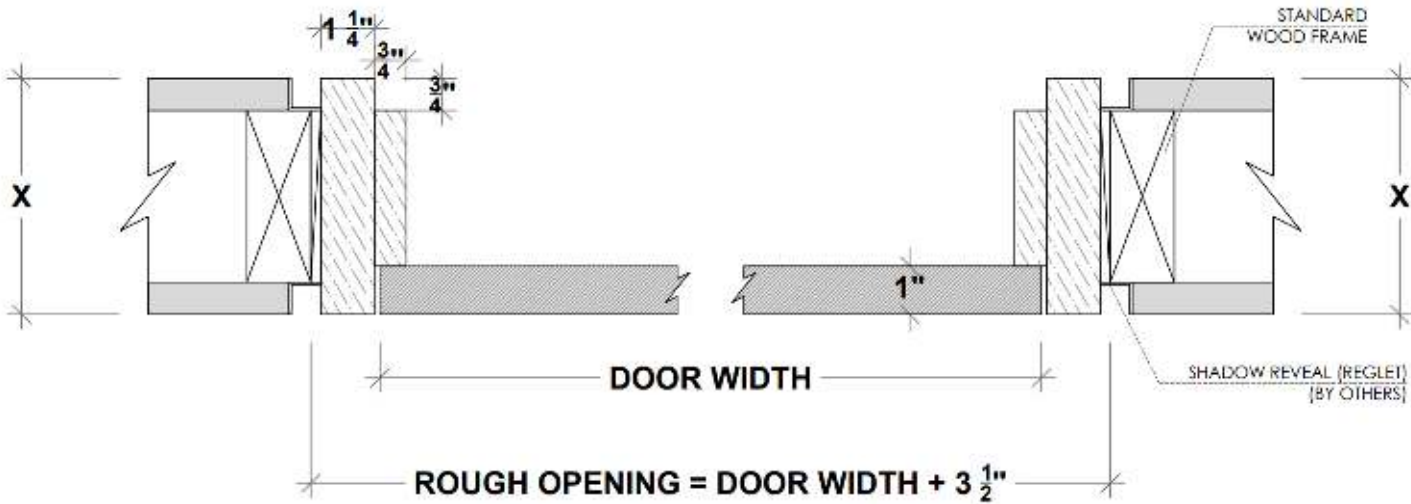

X = THE WALL CAN BE ANY THICKNESS

ALL OPENINGS MUST HAVE WOOD SUPPORT (2" x 4", 2" x 6", 2" x 8", ...)

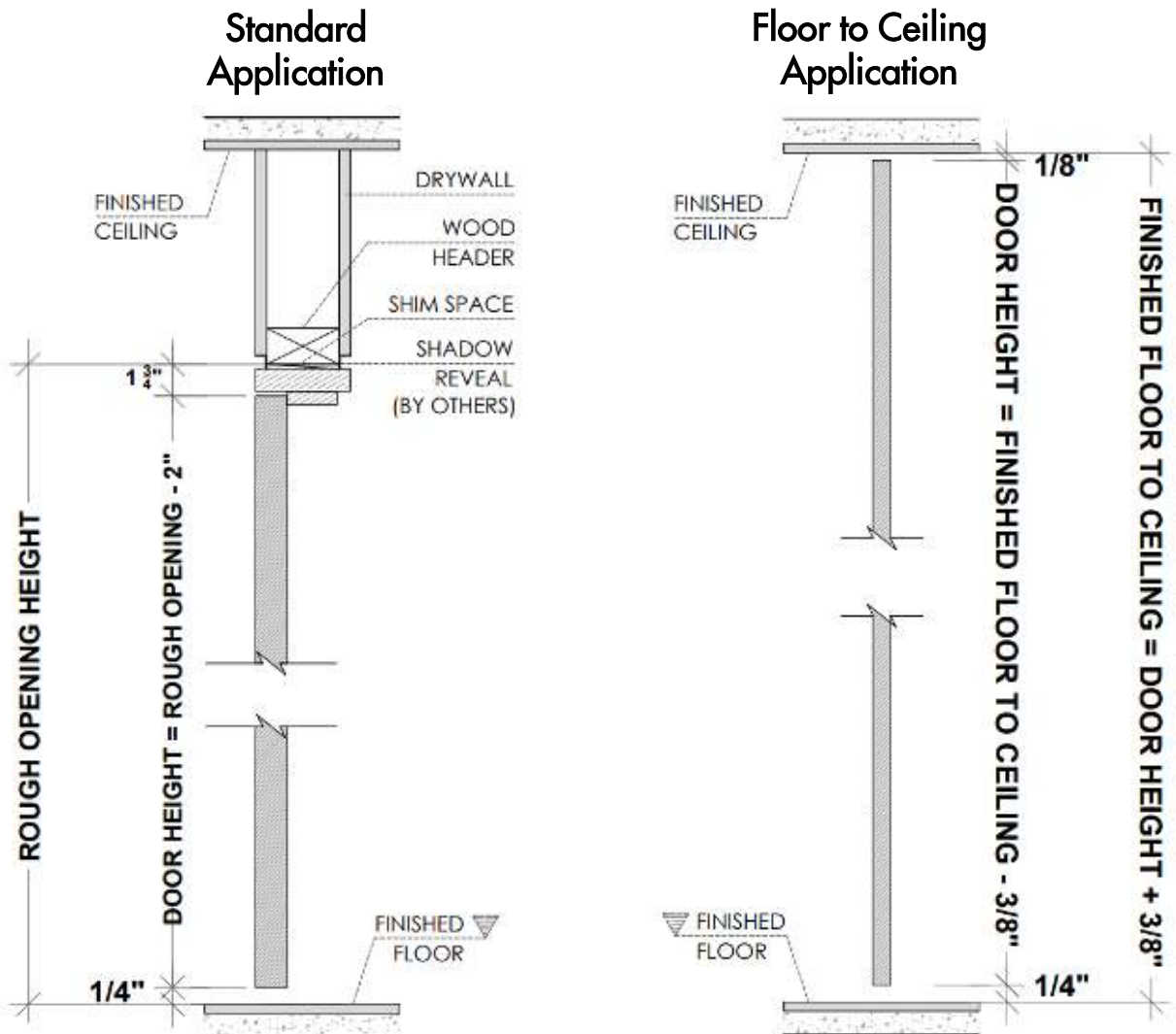

PLEASE ACCOUNT FOR FINISHED FLOOR FOR ALL MEASUREMENTS GIVEN TO DAYORIS.

Outswing Application (euro door only available outswing)

Right Hand Outswing

Left Hand Outswing

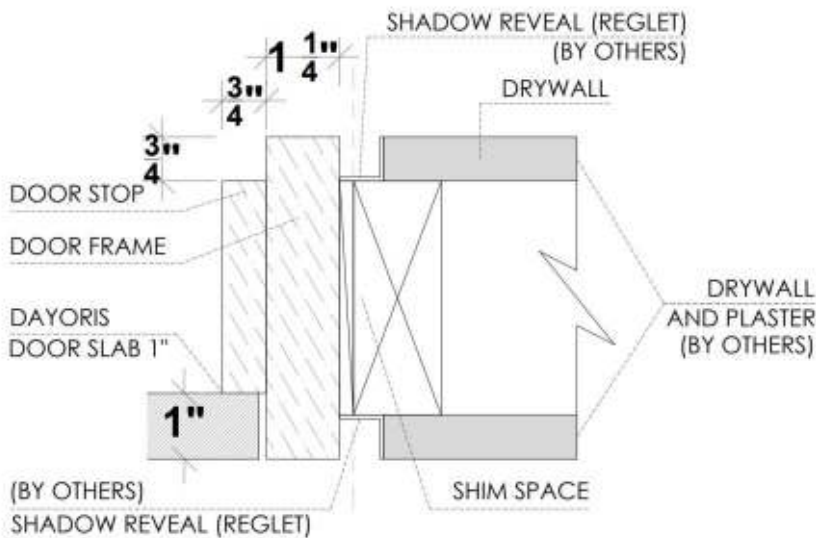
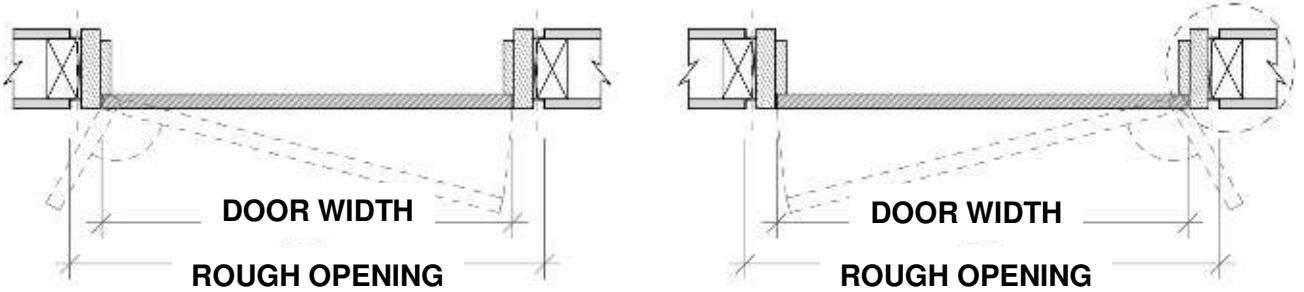

Double Door Applications

Double Dummy Application (both active)

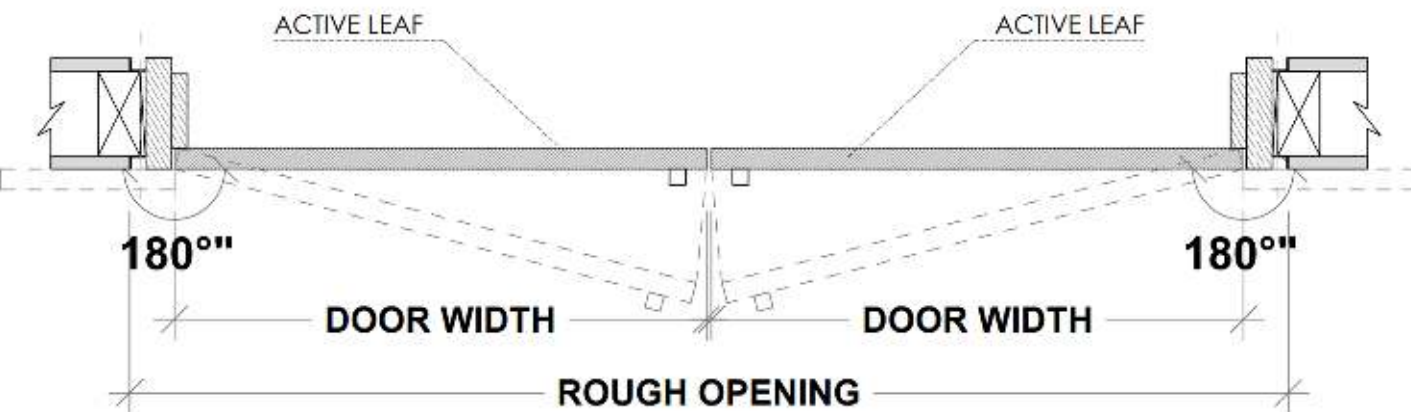

$$\text{ROUGH OPENING} = (\text{DOOR WIDTH} \times 2) + 3 \frac{1}{2}"$$